



TPMS

【 Installation instruction 】

Volkswagen, Audi, Skoda and Seat Direct TPMS Upgrade kit



To ensure correct operation and service,
please read these instructions before installing and operating the TPMS.

Compatible types of displays



Applicable Vehicles



Brand	Model	Generation	Year
Volkswagen	Jetta	MK7	2018~present
	Golf	MK7.5	2017~present
	Golf GTI		
	Golf R		
	Golf Alltrack		
	Golf SportWagen	MK2(1AD)	
	Tiguan		
	Tiguan Limited	B8(3G)	
	Passat		
	Arteon		
Atlas			
Audi	A3 / S3 / RS3	MK3	2018~present
	TT / TTS	MK3	



Check current applicable vehicles and follow us at www.orange-electronic.com for upcoming new vehicle coverage.

Applicable Vehicles



Marca	Modello	Generazione	Anno
Volkswagen	Golf / GTD / TGI	MK7.5	2017~present
	Golf Variant / Alltrack		
	Golf Allestiment Sportivi		
	Passat / Alltrack / Variant	B8(3G)	
	Tiguan / Tiguan Allspace	MK2(1AD)	
	Touran	MK3	
	T-Roc		
	T-Cross		
Audi	A3 / S3 / RS3	MK3	2018~present
	TT / TTS / TTRS	MK3	
Skoda	Octavia	MK3(5E)	
	Superb	MK3(3V)	
	Karoq	MK1	
	Kodiaq	MK1	
Seat	Leon / X-PERIENCE / ST		
	Leon CUPRA / R		
	Ateca		
	Tarraco		



Check current applicable vehicles and follow us at www.orange-electronic.com for upcoming new vehicle coverage.

Applicable Vehicles



Machen	Modell	Generation	Jahr
Volkswagen	Golf / Golf Variant	MK7.5	2017~present
	Golf Sportsvan		
	Passat / Passat Variant	B8(3G)	
	Tiguan / Tiguan Allspace	MK2(1AD)	
	Touran	MK3	2018~present
	Arteon		
	T-Roc		
	T-Cross		
Scirocco			
Audi	A3 / S3 / RS3	MK3	
	TT / TTS / TTRS	MK3	
Skoda	Octavia	MK3(5E)	
	Superb	MK3(3V)	
	Karoq	MK1	
	Kodiaq	MK1	
Seat	Leon / X-PERIENCE / ST		
	Leon CUPRA / R		
	Ateca		
	Tarraco		



Check current applicable vehicles and follow us at www.orange-electronic.com for upcoming new vehicle coverage.

Applicable Vehicles



Brand	Model	Generation	Year
Volkswagen	Golf	MK7.5	2017~present
	Golf Variant		
	Golf Sportsvan		
	Passat / Passat Variant	B8(3G)	
	Tiguan / Tiguan Allspace	MK2(1AD)	
	Touran	MK3	
	Arteon		2018~present
	T-Roc		
T-Cross			
Audi	A3 / S3 / RS3	MK3	
	TT	MK3	
Skoda	Octavia / Octavia Combi	MK3	
	Superb / Superb Combi	MK3	
	Karoq	MK1	
	Kodiaq	MK1	
Seat	Leon / X-PERIENCE / ST		
	Leon CUPRA / R		
	Ateca		
	Tarraco		



Check current applicable vehicles and follow us at www.orange-electronic.com for upcoming new vehicle coverage.

Installation instruction

Step 1 Before installation, make sure your OBD-II and Gateway controller location.

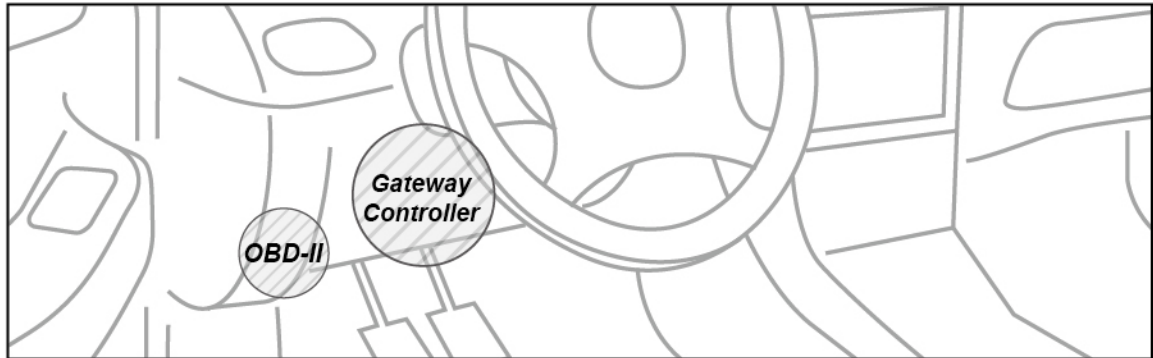

Step 2 Turn on the ignition without start engine, put the coding dongle with receiver into your car's OBD-II connection, and wait another 30 seconds. Turn off the ignition, and the interface can be disconnected.

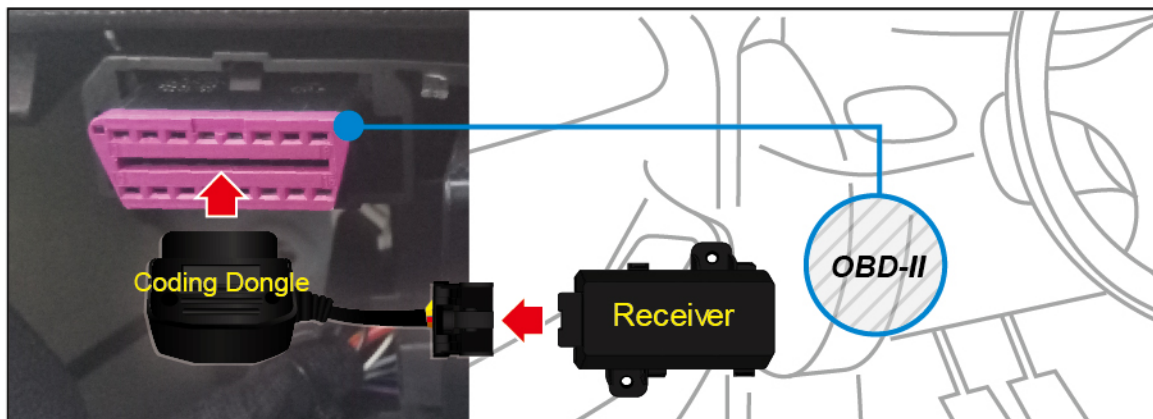

Step 3 Disconnected the red connector from gateway. (Please turn off ignition while doing the process)

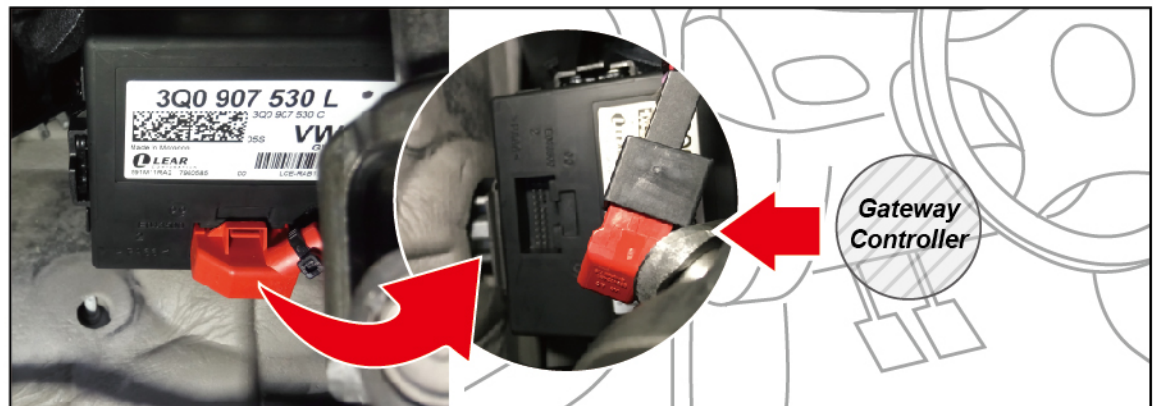

Step 4 There three white connectors (2 male and 1 female) in the cable harness. It depends on infotainment system(MIB) to connect the right one.

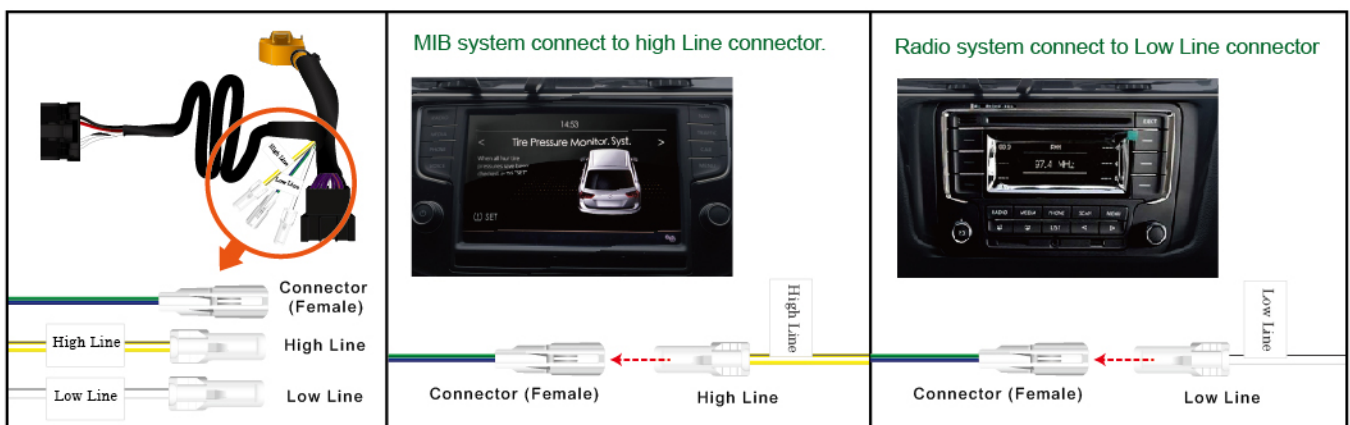

Step 5 Install the cable harness. (Please turn off ignition while doing the process)

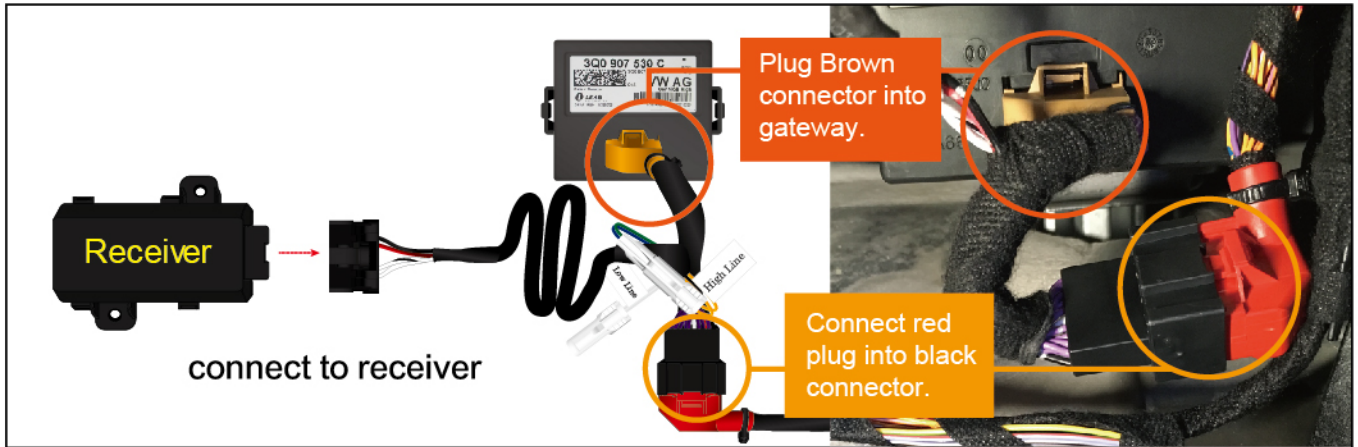

Step 6 Ignition on, you can see the below picture if the previous steps are successful.

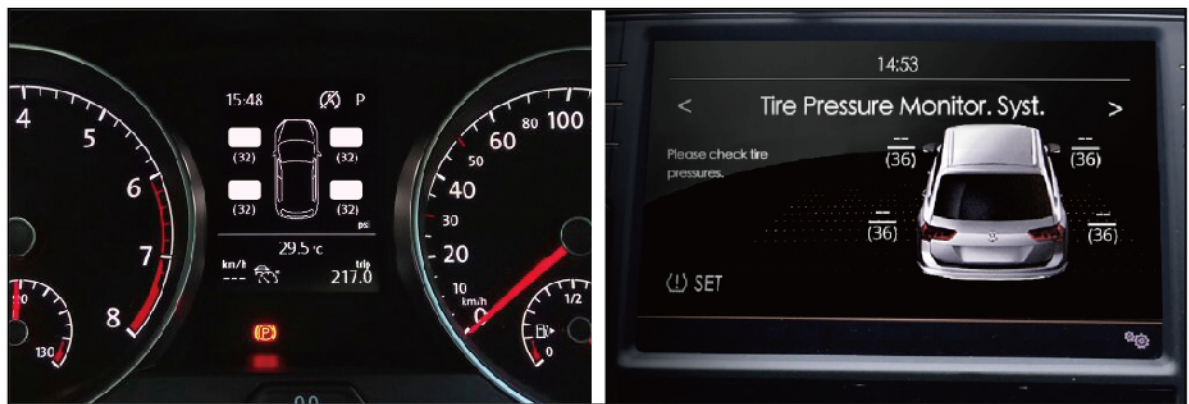

Step 7 Wireless transmitter sensor installation.

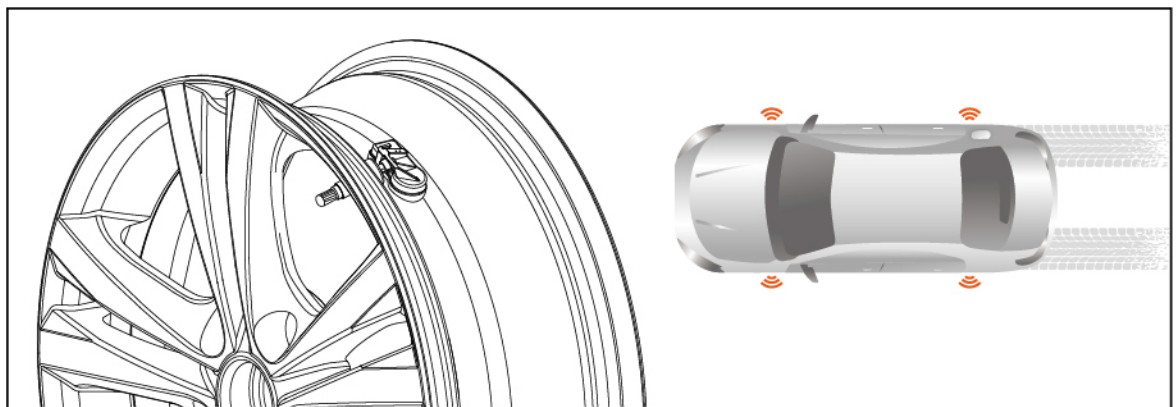

Step 8 After the system is installed, it will automatically monitor the tire pressure. Once the ignition is turned on, and the vehicle is in motion, the display will show the real-time tire pressure .

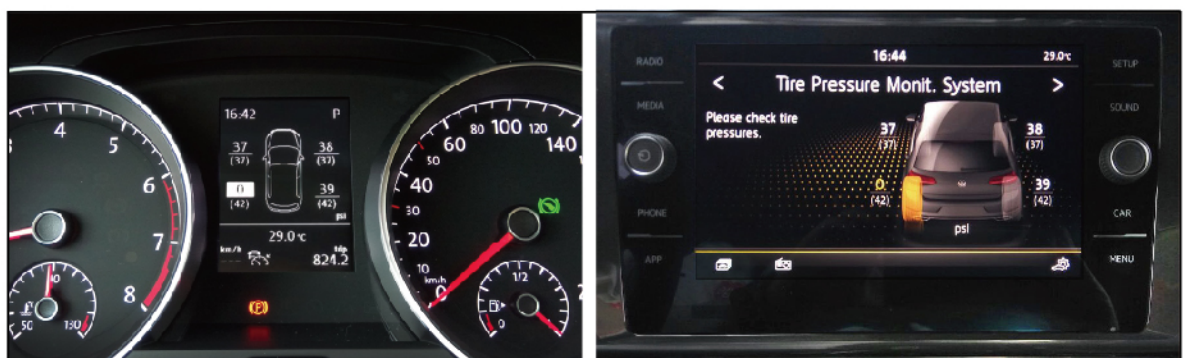

Display operation

Dashboard :

- A. Press "OK" at the right side of steering wheel.
- B. Choose "car condition".
- C. Tire pressure is shown on the dashboard.



Media center :

- A. Press menu at the right side of the monitor.
- B. Choose "car".
- C. Tire pressure is shown on the media center.



Remarks

1. The demo snap shot is for 2018 VW Golf- MK7.5 car model. Different car model may have different screen display for tire pressure.
2. Tire pressure abnormal alarm: when tire pressure is under 20% of set value, TPMS lamp on dashboard and media center will be illuminated and buzzer will be on.
3. Our product is with OTO (Orange Tire Orientation) function. When you rotate tires, you just need to drive the car a while, and the sensors will be relearn automatically.

Warning

- After installation, when you back to tire shop for maintenance, please turn off the function.
After tire shop maintenance, please re-activate the function.
- Sometime, it may cause the auto-location function fail.

Trouble Shooting

The dashboard doesn't show any tire pressure information.



1. Please be sure the car model is suitable for this upgrade.

Trouble shooting: please check product website to see whether the car model is suitable for the upgrade.

2. Check if the receiver and power line are properly installed.

Trouble shooting: Unplug and re-connect receiver and power line.

3. The system is not properly initiated.

Trouble shooting: Back to the store where you installed the system, remove the receiver and re-installed the system from beginning. And confirm the system is correctly installed.

The system couldn't show tire pressure.

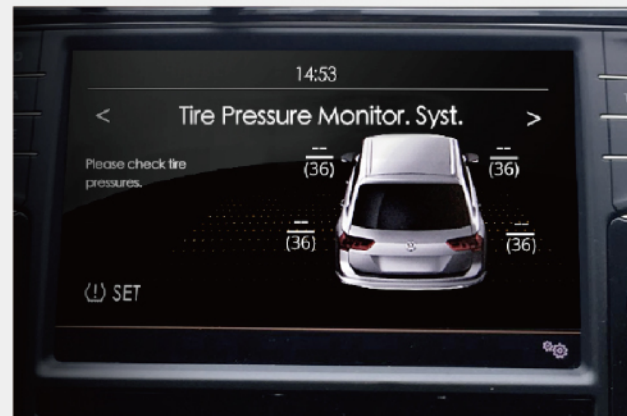

1. Other electronic devices in car interference the sensor signal.

Trouble shooting: Remove other electronic devices from power to identify the source of interference.

2. Sensors don't send out signal

Trouble shooting: Drive the car for 3 to 5 minutes to let the car receive sensor signal.

3. Receiver and sensors are not properly matching.

Trouble shooting: In relearn mode, to let receiver re-learn sensor IDs.

4. Sensor mal-function

Trouble shooting: If after re-do the relearn procedure, the receiver still couldn't learn sensor IDs, then the sensors are mal-function. Please go back to your installation dealer for repair or change new sensors.

Receiver couldn't learn sensors IDs

When no other electronic devices are interfering sensor signal, and the car has been driving for 3 to 5 minutes, the receiver still could learn sensor IDs, please follow the below procedures to re-learn:

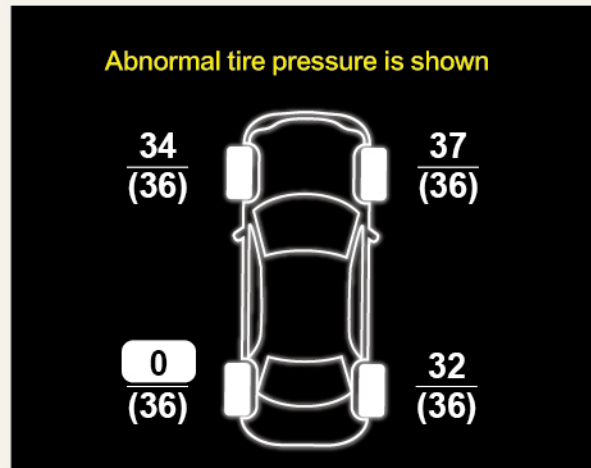
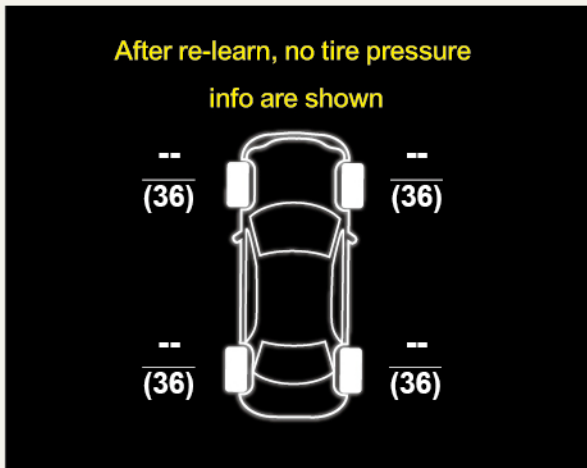

Relearn procedures:

1. Turn off the the light signal.
2. Press headlight once and press hazard warning light once, repeat the process for 4 times to re-learn mode.
3. Start deflate re-learn procedure in the following order - RF, RR, LR, and LR.

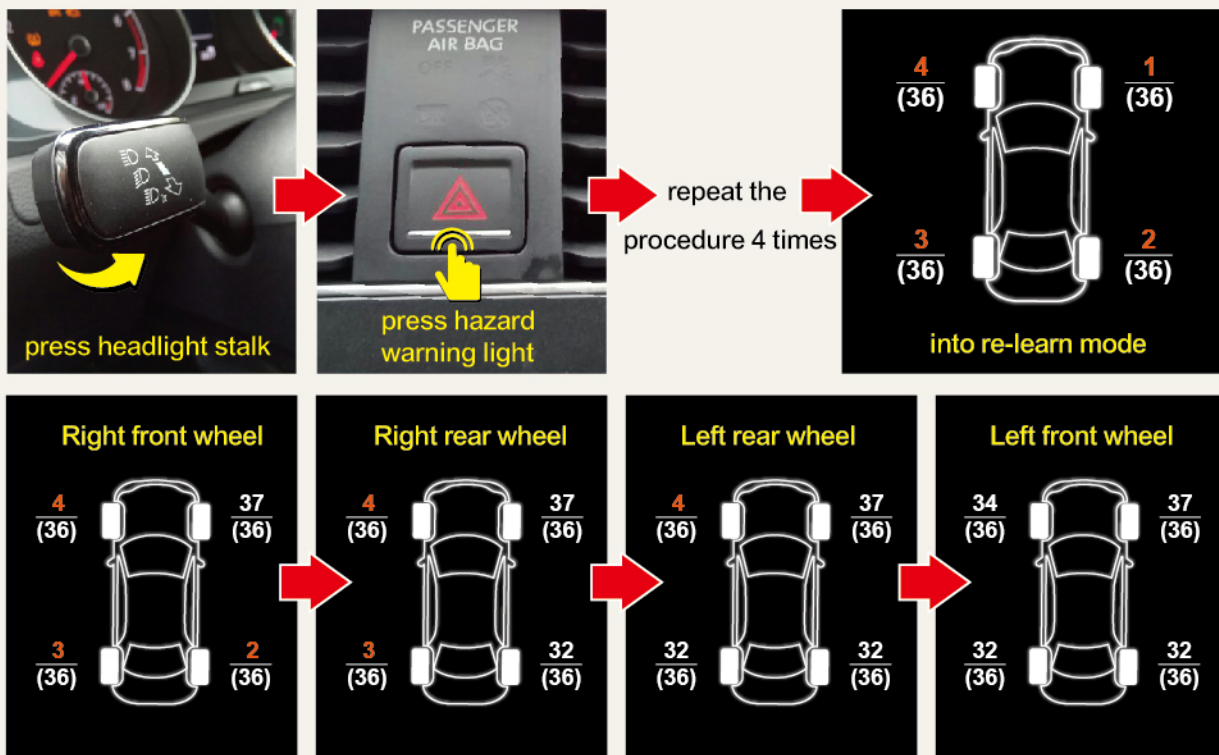

Product Components

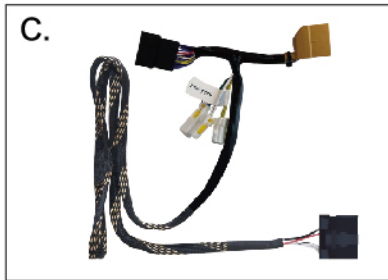
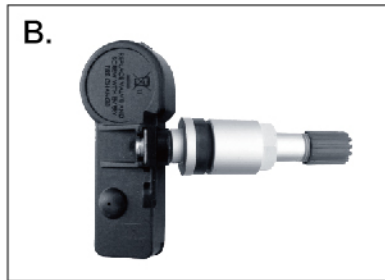

- A. Receiver
- B. Sensor X 4
- C. Orange 3-way (cable harness)
- D. Cable Ties X 2



Product specifications

Product Model : PVW02 VW Direct TPMS Upgrade kit

Receiver Specifications

Operating Frequency	433.92MHZ
Operating Voltage	DC 9V ~ 16V

Sensor Specifications

Operating Temperature	-40°C to 125°C (same as OE standard)
Operating Humidity	Maximum 95%
Operating Frequency	433.92MHZ ± 50kHz
Pressure Monitoring Range	0~74 psi (0~ 5.1 bar)
Pressure Reading Accuracy	± 1.5 psi (± 0.1 bar)
Temperature Reading Accuracy	± 3°C
Weight	32g ± 3g

For the latest information, please visit our website.
Thank you for your purchase and safe driving!

Manufacturer by : Orange Electronic Co., LTD

Website : www.orange-electronic.com

Orange P : +1(310)377-8835

Orange F : +1(248)856-3910

Toll free for U.S. & Canada : 1866-492-4170

8255 Cascade Avenue, Suite 220, Commerce Township, MI 48382

Email : service@orange-electronic.com